

DE SERIES - BULLET RESISTANT DOORS

DE Series Bullet Resistant Doors shall be as manufactured or furnished by Republic Doors and Frames, McKenzie, Tennessee 38201.

Thickness - 1-13/16" (+/- 1/16")

Actual Door Size - Door undersized from nominal by 1/4" in width and 7/8" in height. Standard undercut is 3/4".

Hinge Rail & Reinforcement - Hinge edge is non-beveled and reinforced with a continuous 10 gage steel channel projection welded at a maximum 5" on center.

Lock Rail - Lock edge is non-beveled and reinforced with a continuous 14 gage steel channel projection welded at a maximum 5" on center. (Beveled lock edge 1/8" in 2" optional.)

Top Channel - Top Channel is a flush 16 gage channel, projection welded at a maximum 2-1/2" on center.

Bottom Channel - Bottom Channel is an inverted steel 16 gage channel, projection welded at a maximum 2-1/2" on center.

Cores Available - Polystyrene Insulated.

Face Skins - 14 gage (cold rolled steel or galvanealed)

Closer Reinforcement (Optional) - When closer reinforcements requested 14 gage standard / 12 gage optional. (18" x 6")

Size Availability - (Singles) Maximum 5'0" x 10'0" (Pairs) (*Levels 1-3 only) Maximum 10'0" x 10'0"
Note(7 gage Astragal required on all paired openings)*

SDI 100 Grade/Model - Grade Levels 1-4 Model 1 or 2 (Maximum Duty Performance Level A)
(Standard)

Label Range - Bullet Resistant label per ballistic requirement as needed - Refer to Label Section for DE414 fire ratings

Edge Seam Construction - Visible seam, continuously welded seamless and intermittently welded seamless available.

Universal Standard/Heavy Weight Hinge - Hinge fillers are used allowing for an easy modification from standard to heavy weight hinge prep. Levels 1, 2, 3 and 6 come standard with 4-1/2" hinges up to 3480 doors - Levels 4, 5, 7 and 8 are recommended to be prepped for continuous geared hinge.

Handing Design - Non-Handed standard (Handed optional)

Lite Kits and Louvers - Available (Contact Factory)

Revised 8/09

DE SERIES - BULLET RESISTANT DOOR CONSTRUCTION - LEVEL 1

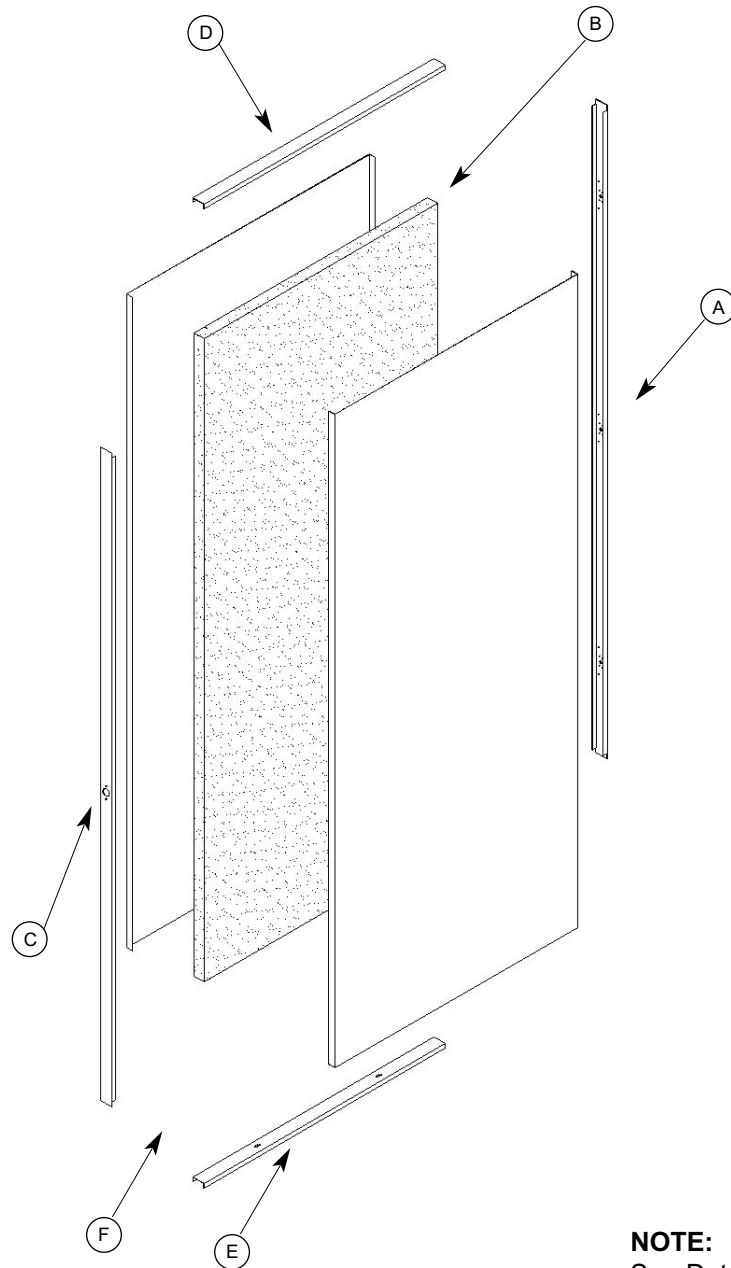

NOTE:
See Details on
back of page.

Revised 7/06

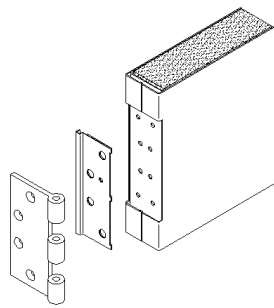
A

Continuous 10 gage reinforcement steel channel compatible with 4-1/12" or 5" full mortise template hinges on 1-3/4" doors

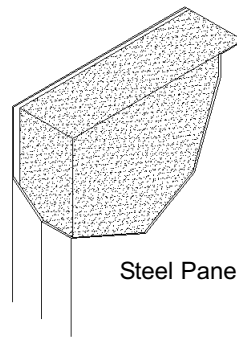
B

Steel Panel

Polystyrene

C

14 gage continuous lock channel

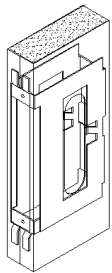

16 gage mortise lock reinforcement with provisions for Gov't Series 86 mortise lockset and ANSI A115.1 lock front (1-1/4" x 8")

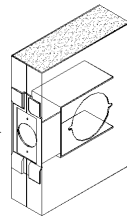

16 gage steel cylindrical lock reinforcement with provisions for Gov't Series 160 or 161 cylindrical lock sets (2-3/4" backset) and ANSI A115.2 lock front (1-1/8" x 2-1/4")

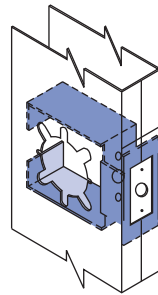

Lever Lock Prep - 161 DT (Modified 161 Prep) Conforms with the ANSI 115.18 161 lever lock specifications.

WARNING: Use rose trim with a minimum diameter of 3-5/16" to cover prep.

D

Flush top continuous 16 gage steel channel

DOOR TOP

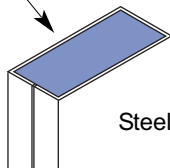

Steel Panel

When closer reinforcements requested 14 gage standard / 12 gage optional

E

DOOR BOTTOM

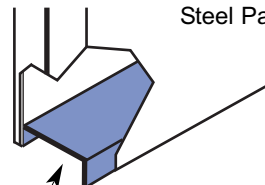

Steel Panel

Continuous 16 gage steel channel

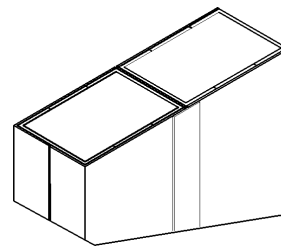
F

7 gage flat astragal for double doors

DE SERIES - BULLET RESISTANT DOOR CONSTRUCTION - LEVEL 2 & 3

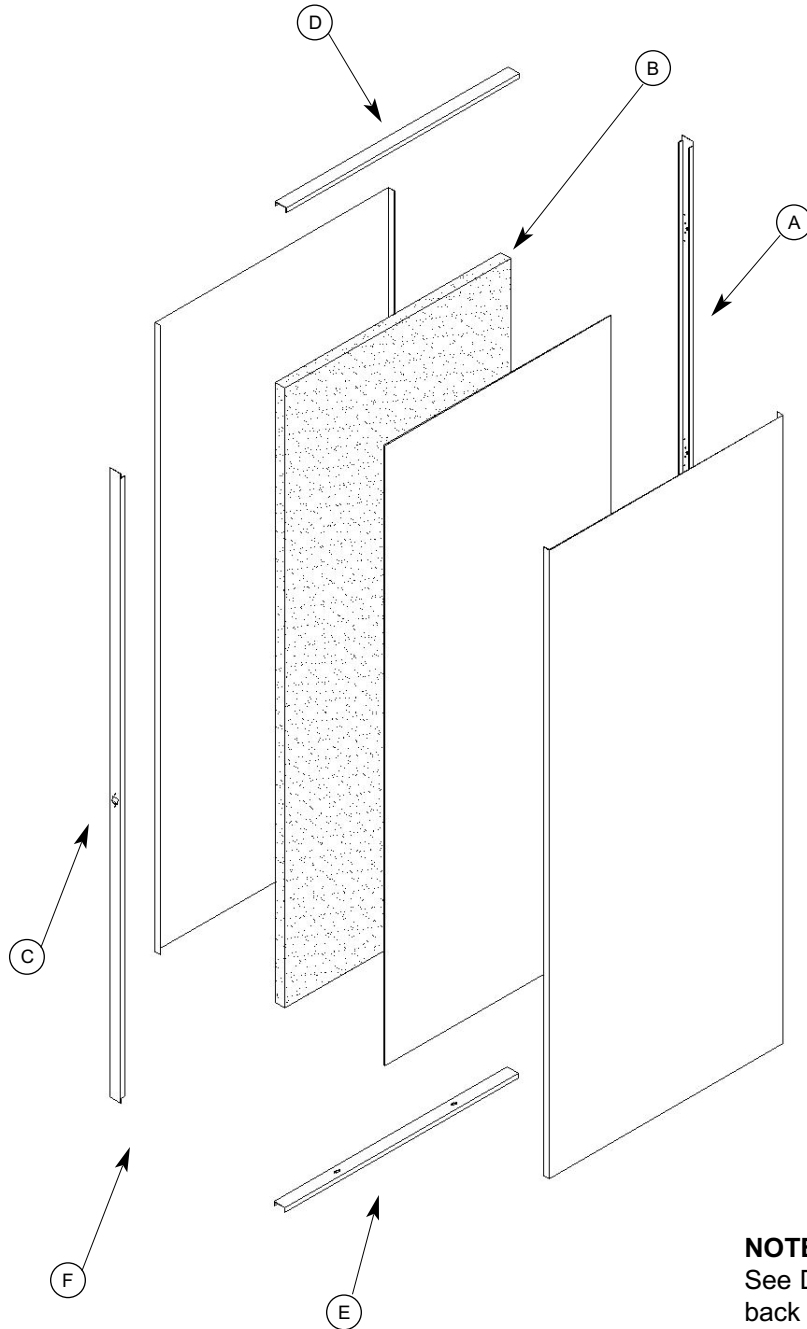

NOTE:
See Details on
back of page.

Revised 7/06

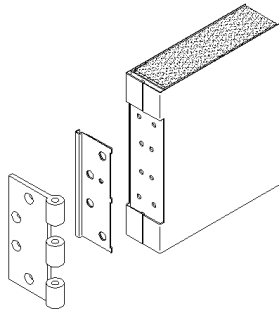
A

Continuous 10 gage steel channel compatible with 4-1/12" x 4-1/2" full mortise template hinges on 1-3/4" doors.

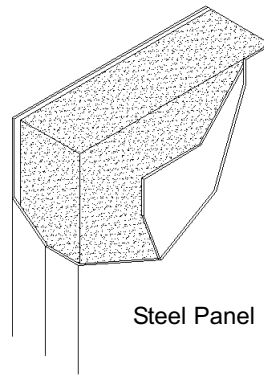
B

Steel Panel

Polystyrene with Armor Plate

C

14 gage continuous lock channel

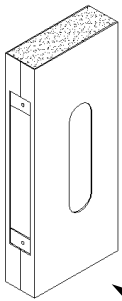

16 gage mortise lock reinforcement with provisions for Gov't Series 86 mortise lockset and ANSI A115.1 lock front (1-1/4" x 8")

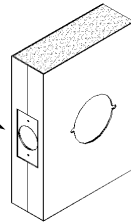

16 gage steel cylindrical lock reinforcement with provisions for Gov't Series 160 or 161 cylindrical lock sets (2-3/4" backset) and ANSI A115.2 lock front (1-1/8" x 2-1/4")

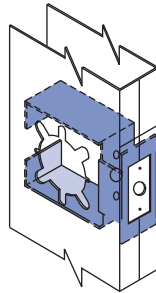

Lever Lock Prep - 161 DT (Modified 161 Prep) Conforms with the ANSI 115.18 161 lever lock specifications.

WARNING: Use rose trim with a minimum diameter of 3-5/16" to cover prep.

D

Flush top continuous 16 gage steel channel

DOOR TOP

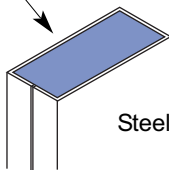

Steel Panel

When closer reinforcements requested 14 gage standard / 12 gage optional

E

DOOR BOTTOM

Steel Panel

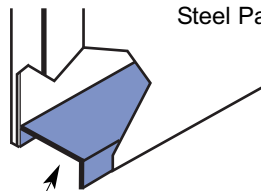

Continuous 16 gage steel channel

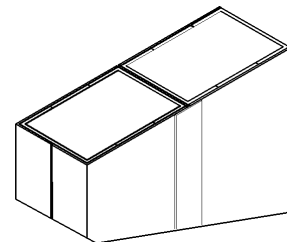
F

7 gage astragal for double doors (optional)

DE SERIES - BULLET RESISTANT DOOR CONSTRUCTION - LEVEL 4 THRU 8

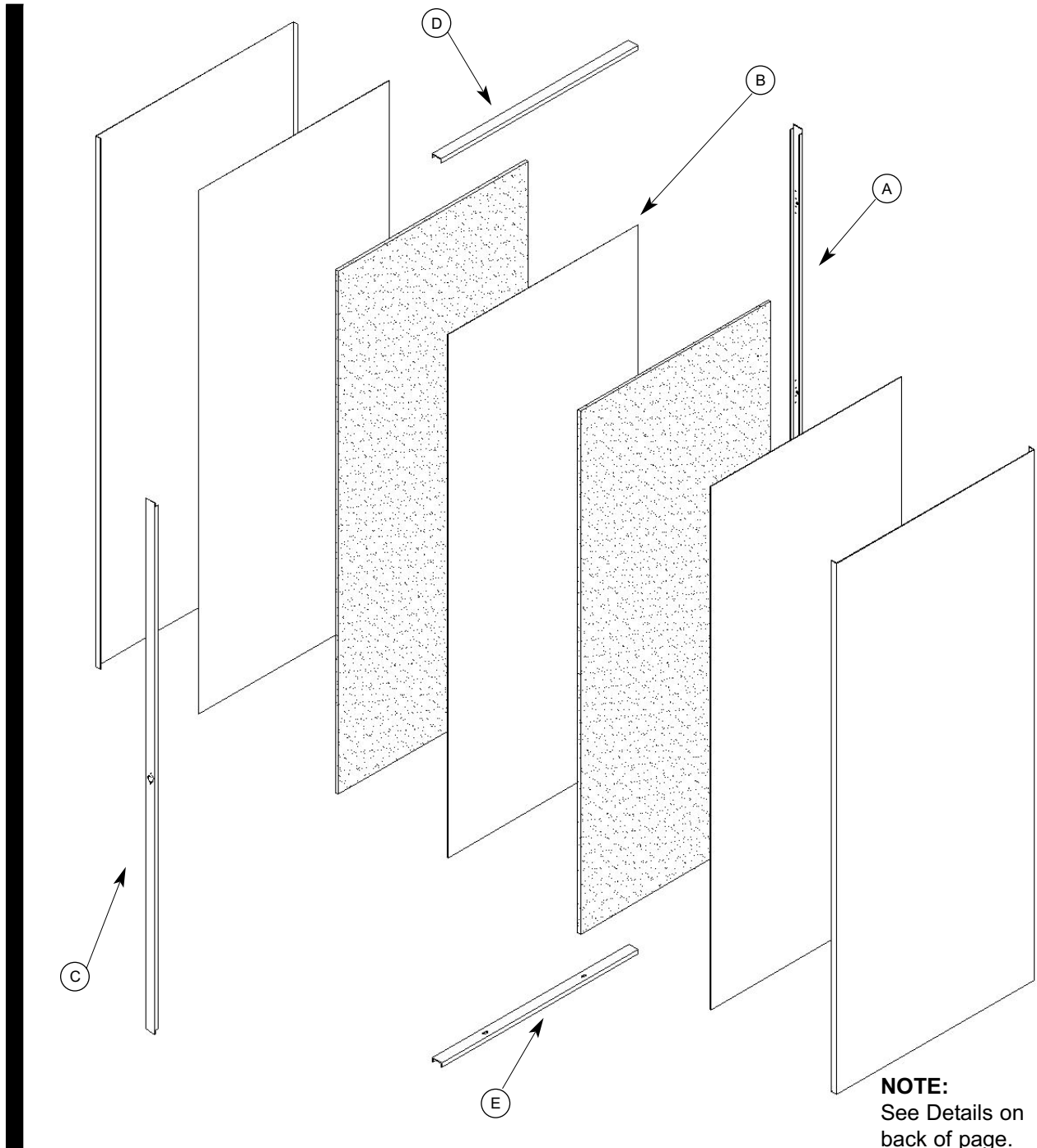

Revised 7/06

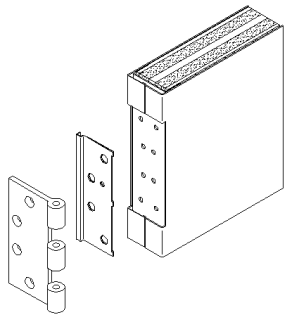
A

Continuous 10 gage reinforcement steel channel compatible with 4-1/12" or 5" full mortise template hinges on 1-3/4" doors.

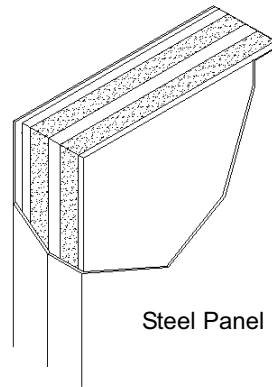
B

Steel Panel

2 pieces of 1/2" Polystyrene
or 1.5 lb. Fiberglass Batting
3 Armor Plates

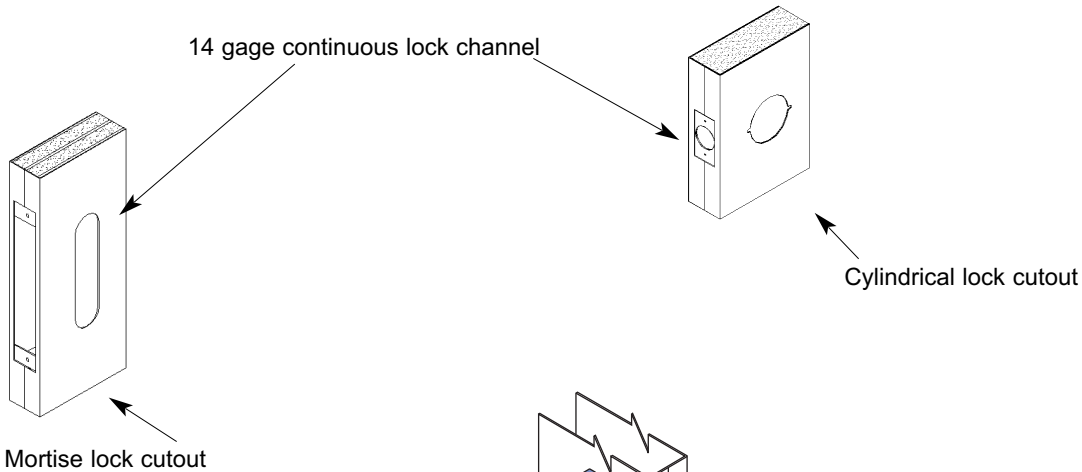
C

14 gage continuous lock channel

Cylindrical lock cutout

Mortise lock cutout

Lever Lock Prep - 161 DT (Modified 161 Prep) Conforms with the ANSI 115.18 161 lever lock specifications.

WARNING: Use rose trim with a minimum diameter of 3-5/16" to cover prep.

D

Flush top continuous 16 gage steel channel
DOOR TOP

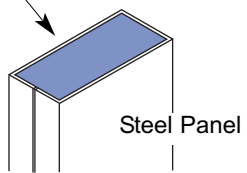

Steel Panel

When closer reinforcements requested 14 gage standard / 12 gage optional

E

DOOR BOTTOM

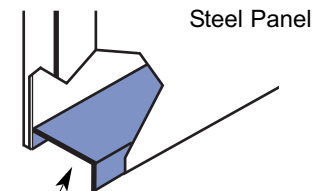

Steel Panel

Continuous 16 gage steel channel